

Montageanleitung SE-Griffe

Biko/Cosmo/Mimas/
Narvi/Pan/Puck

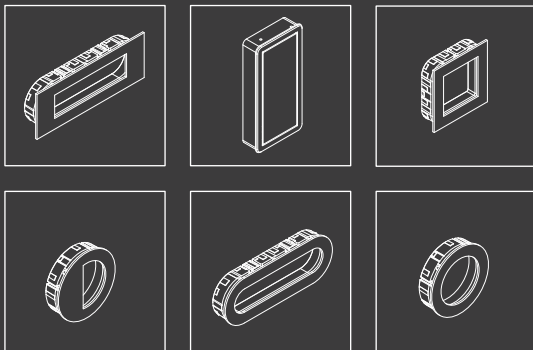

Smart Entrance

BY POLLMEIER

MONTAGEANLEITUNG

SE-Griffe Biko/Mimas/Narvi/Pan/Puck

Komponenten

Griff-Set Biko

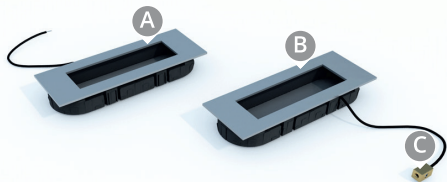

Griff-Set Cosmo

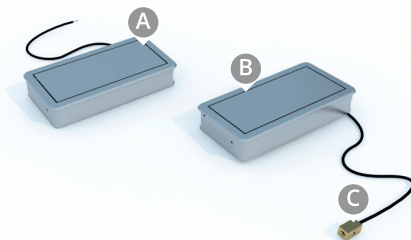

Komponenten

Griff-Set Mimas

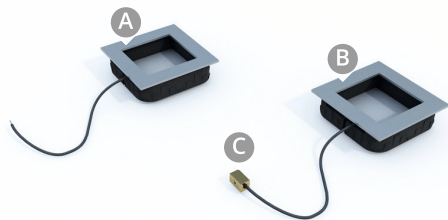

Griff-Set Narvi



Komponenten

Griff-Set Pan

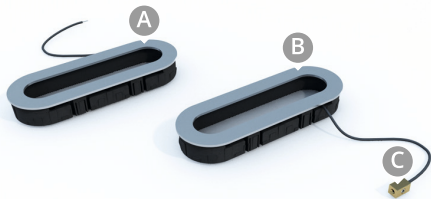

Griff-Set Puck

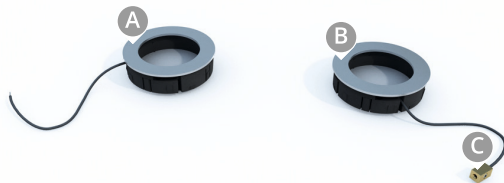

Sicherheitshinweis

ACHTUNG!

Bauen Sie die eingelassenen Griffe Biko, Cosmo, Mimas, Narvi, Pan und Puck nur in stumpfe Türen ein!

Der Einbau in gefälzte Türen ist nicht zulässig, da sonst eine Notentriegelung des Schlosses nicht mehr möglich ist.

MONTAGEANLEITUNG

SE-Griffe Biko/Mimas/Narvi/Pan/Puck

Fräsmaße

Griff-Set Biko/Pan

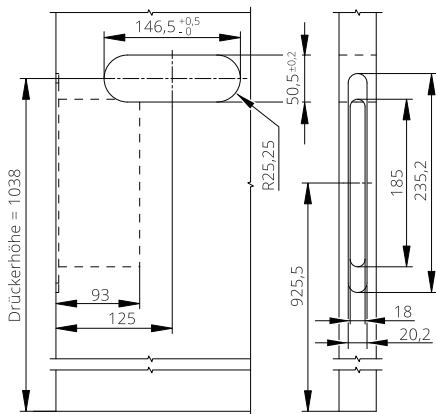

Griff-Set Cosmo

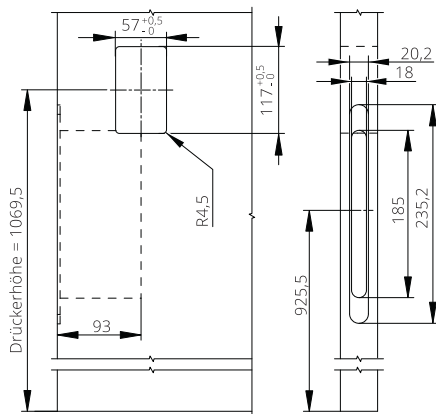



Fräsmaße

Griff-Set Mimas

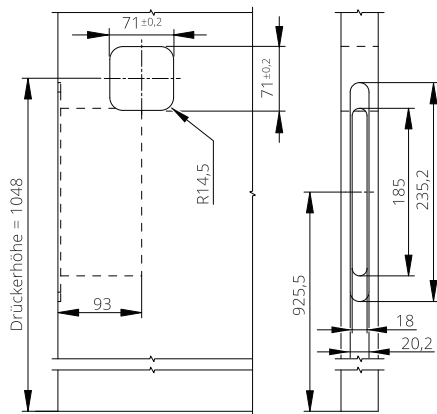

Griff-Set Narvi/Puck

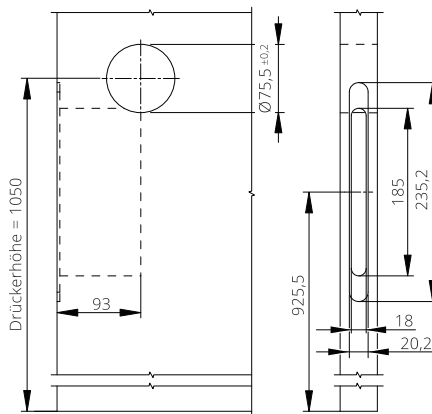

MONTAGEANLEITUNG

SE-Griffe Biko/Mimas/Narvi/Pan/Puck

Montageschritt 1

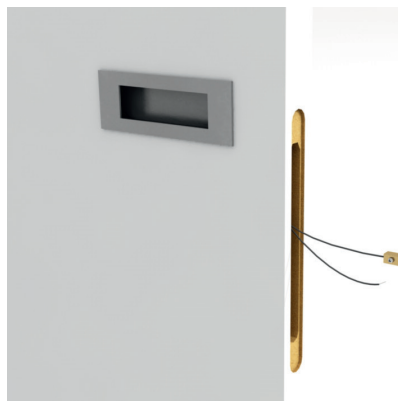
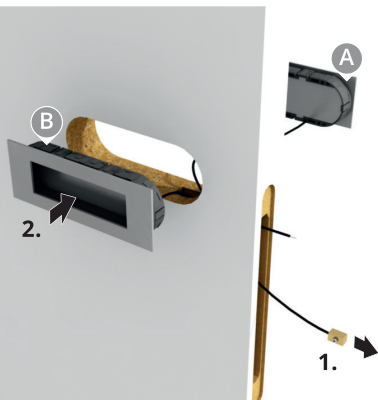

Damit die Kabel nicht beschädigt werden, die Kabelkanäle an den klemmbaren Griffen nutzen!
Der Cosmo-Griff muss geklebt werden und besitzt keine Kabelkanäle.

Montageschritt 2

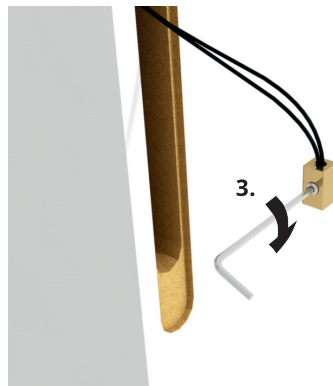
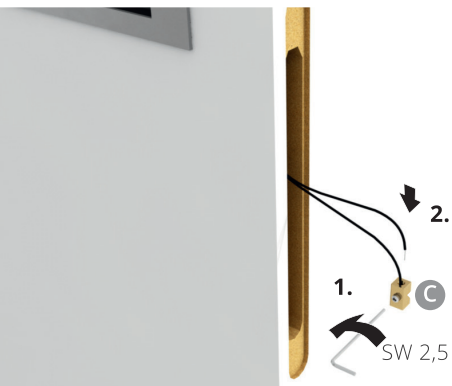

Montageschritt 3



Montageschritt 4





Smart Entrance

BY POLLMEIER