

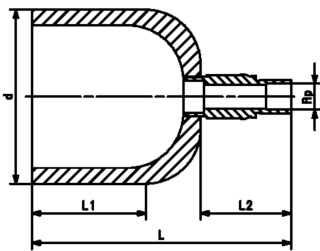

COOL-FIT 2.0/4.0 Übergangskappe PE/Messing Mit Innengewinde Rp

Ausführung:

- Stutzenfitting PE100 SDR11, metrisch mit freiem Ende
- Messing CuZn40Pb2 mit Innengewinde Rp
- Dichtung: O-Ring EPDM



d	DN	SDR	PN	Code	NPK	Gewicht	Gewinde	Zoll	L	L1	L2
(mm)	(mm)		(bar)			(kg)		(inch)	(mm)	(mm)	(mm)
32	25	11	16	738 960 008		0.200	Rp	½	107	36	69
40	32	11	16	738 960 009		0.210	Rp	½	113	40	73
50	40	11	16	738 960 010		0.250	Rp	½	117	44	73
63	50	11	16	738 960 011		0.300	Rp	½	121	48	73
75	65	11	16	738 960 012		0.400	Rp	½	128	55	73
90	80	11	16	738 960 013		0.476	Rp	½	135	62	73
110	100	11	16	738 960 014		0.695	Rp	½	145	72	73
140	125	11	16	738 960 016		0.954	Rp	½	209	84	73
160	150	11	16	738 960 017		1.300	Rp	½	193	90	73
225	200	11	16	738 960 020		2.532	Rp	½	221	110	73

The technical data are not binding. They neither constitute expressly warranted characteristics nor guaranteed properties nor a guaranteed durability. They are subject to modification. Our General Terms of Sale apply.

Georg Fischer Piping Systems Ltd, Postfach, CH-8201 Schaffhausen/Switzerland Phone +41 -(0)52-631 1111 e-mail: info.ps@georgfischer.com Internet: <http://www.gfps.com>