



COOL-FIT 2.0/4.0 Einschweiss-Nippel PE/iFIT

Ausführung:

- Material: PE100, Messing
- Mit Einschweiss-Nippel-Konus (PE100) und iFIT Modul (Messing) für den Übergang auf COOL-FIT Push System oder iFIT
- Dichtung: O-Ring EPDM

Anmerkung:

Für Rohre COOL-FIT 2.0, COOL-FIT 2.0F, COOL-FIT 4.0 und COOL-FIT 4.0F

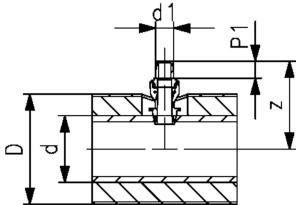

d1 (mm)	PN (bar)	Code	Gewicht (kg)	z (mm)	P1 (mm)	d COOL-FIT 2.0 (mm)	d COOL-FIT 4.0 (mm)
25/32	16	738 110 407	0.228	92 + d/2	28	d63 - d140	d63 - d225

The technical data are not binding. They neither constitute expressly warranted characteristics nor guaranteed properties nor a guaranteed durability. They are subject to modification. Our General Terms of Sale apply.

Georg Fischer Piping Systems Ltd, Postfach, CH-8201 Schaffhausen/Switzerland

Phone +41 -(0)52-631 1111

e-mail: info.ps@georgfischer.com

Internet: <http://www.gfps.com>