



## COOL-FIT 4.0 Einschweiss-Nippel PE Stutzen

### Ausführung:

- Werkstoff: PE100
- Mit Einschweiss-Nippel-Konus (PE100) und metrischem Stutzen SDR11 für COOL-FIT 4.0 Fittings Typ A oder PE Fittings
- Inklusive Dämmung aus EPDM Schaum

### Anmerkung:

Für Rohre COOL-FIT 2.0, COOL-FIT 2.0F, COOL-FIT 4.0 und COOL-FIT 4.0F

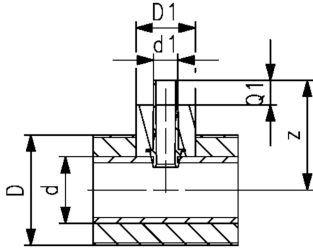

d1 (mm)	SDR	PN (bar)	Code NPK	Gewicht (kg)	z (mm)	Q1 (mm)	D1 (mm)	d COOL-FIT 4.0 (mm)
32	11	16	<b>738 113 608</b>	0.075	125 + d/2	36	78	d63 - d225
40	11	16	<b>738 113 609</b>	0.107	131 + d/2	40	85	d75 - d225
50	11	16	<b>738 113 610</b>	0.163	140 + d/2	44	110	d90 - d225

The technical data are not binding. They neither constitute expressly warranted characteristics nor guaranteed properties nor a guaranteed durability. They are subject to modification. Our General Terms of Sale apply.

Georg Fischer Piping Systems Ltd, Postfach, CH-8201 Schaffhausen/Switzerland Phone +41 -(0)52-631 1111 e-mail: info.ps@georgfischer.com Internet: <http://www.gfps.com>