

COOL-FIT 4.0 Reduktion, d32-d225

Ausführung:

- Vorisoliertes PE100 SDR11, metrisch
- Isolation aus GF HE Schaum
- Schutzmantel schlagfest. Farbe: schwarz
- A: Elektroschweissfitting mit integrierter Dichtungslippe für eine wasser- und dampfdichte Verbindung
- B: Stumpfschweissfitting mit freiem Ende

* 160/250 - 140/200 + 223/315 - 140/200 verfügbar ab 08.2019

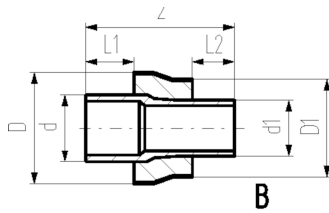
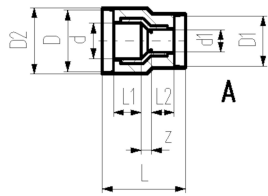

d/D1 (mm)	d1/D1 (mm)	d1 (mm)	PN (bar)	Code	SP	Gewicht (kg)	GP
40/110	32/90	32/90	16	738 903 206	1	0.250	6
50/110	32/90	32/90	16	738 903 209	1	0.280	6
50/110	40/110	40/110	16	738 903 210	1	0.320	6
63/125	32/90	32/90	16	738 903 212	1	0.217	6
63/125	40/110	40/110	16	738 903 213	1	0.232	6
63/125	50/110	50/110	16	738 903 214	1	0.243	6
75/140	63/125	63/125	16	738 903 318	1	0.264	4
90/160	63/125	63/125	16	738 903 322	1	0.387	2
90/160	75/140	75/140	16	738 903 323	1	0.416	2
110/180	63/125	63/125	16	738 903 327	1	0.566	2
110/180	75/140	75/140	16	738 903 328	1	0.577	2
110/180	90/160	90/160	16	738 903 329	1	0.644	2
160/250	63/125	63/125	16	738 903 347	1	1.298	2
160/250	90/160	90/140	16	738 903 349	1	1.323	2
160/250	110/180	110/160	16	738 903 350	1	1.362	2
*	140/200		16	738 904 351	1	1.664	2
225/315	63/125	63/125	16	738 903 364	1	2.960	2
225/315	90/160	90/160	16	738 903 366	1	3.018	2
225/315	110/180	110/180	16	738 903 367	1	3.079	2
*	140/200		16	738 904 368	1	3.172	2
225/315	160/250	160/225	16	738 903 369	1	3.550	2

d/D1 (mm)	d1/D1 (mm)	d1 (mm)	L (mm)	L1 (mm)	L2 (mm)	z (mm)	Typ	D2 (mm)
40/110	32/90	32/90	143	40	36	17	A	117
50/110	32/90	32/90	151	44	36	21	A	117
50/110	40/110	40/110	149	44	40	15	A	117
63/125	32/90	32/90	160	48	36	26	A	132
63/125	40/110	40/110	159	48	40	21	A	132
63/125	50/110	50/110	159	48	44	17	A	132
75/140	63/125	63/125		55	48	170	B	
90/160	63/125	63/125		62	48	190	B	
90/160	75/140	75/140		62	55	189	B	
110/180	63/125	63/125		72	48	204	B	
110/180	75/140	75/140		72	55	205	B	
110/180	90/160	90/160		72	62	205	B	
160/250	63/125	63/125		90	48	244	B	
160/250	90/160	90/140		90	62	244	B	
160/250	110/180	110/160		90	72	242	B	
*	140/200			90	84	257	B	
225/315	63/125	63/125		110	48	295	B	
225/315	90/160	90/160		110	62	295	B	
225/315	110/180	110/180		110	72	295	B	
*	140/200			110	84	296	B	
225/315	160/250	160/225		110	90	279	B	

The technical data are not binding. They neither constitute expressly warranted characteristics nor guaranteed properties nor a guaranteed durability. They are subject to modification. Our General Terms of Sale apply.

Georg Fischer Piping Systems Ltd, Postfach, CH-8201 Schaffhausen/Switzerland

Phone +41 -(0)52-631 1111

e-mail: info.ps@georgfischer.com

Internet: <http://www.gfps.com>